

Taper Pins:

Plain, extractable or custom-made taper pins to customer specification

Plain & Extractable Taper Pins

The Technifast standard range of plain taper pins are made to DIN 1B, we also offer extractable taper pins to DIN 7977 and 7978.

Taper Pin Manufacturing

As well as our stocked taper pins, we offer non-standard diameters up to a maximum of 32mm. We also offer non-standard taper angles, a ground finish and lengths up to 300mm. We welcome enquiries for split taper pins, which can be produced to a customers unique specifications.

Standards

DIN 1B taper pins are most commonly made from mild steel but we also manufacture in stainless 303 and 316. The nominal length excludes the radiused ends and the taper is 1-in-50. EG: a 6 x 50 taper pin will be 6mm at the small end and 7mm at the large end with an overall length of approximately 53mm.

DIN 1A taper pins are similar to DIN 1B but they differ in their surface quality. DIN 1A taper pins have a ground surface whereas DIN 1B pins only have a turned finish.

DIN 7977 taper pins are threaded with a male thread for extraction purposes. Commonly made in mild steel and stainless steel 303, they are also frequently manufactured in marine grade 316 stainless steel. The length includes the thread which should be taken into account depending on how long you want the taper to be. As with the DIN 1B taper pins the taper has a 1-in-50 gradient.

DIN 7978 taper pins have a female thread for extraction. With a 1-in-50 taper gradient this pin is most commonly manufactured in mild steel and stainless steel 303. We can also supply hardened and in other materials, including marine grade stainless steel 316.



Standards:

- DIN 1A - Plain Taper Pin With A Ground Finish (Surface Roughness of 0.8 Microns)
- DIN 1B - Plain Taper Pin With A Ground Finish (Surface Roughness Of 3.2 Microns)
- DIN 7978 - Extractable Taper Pin With Female Thread
- DIN 7977 - Extractable Taper Pin With Male Thread
- ISO 2339 - Same As DIN 1B But Length Includes Crowns
- ISO 8736 - Same As DIN 7978 With Minor Tolerance Changes
- ISO 8737 - Same As DIN 7977 With Minor Tolerance Changes
- BS 46 PT 3 - Inch Range With Nominal Diameter Being The Large End And A Taper Of 1 In 48
- BS 1804 PT 3 - Extractable Taper Pin
- BS 5681 - Same As ISO 2339
- DIN 258 - Variant Form Of DIN 7977

Materials:

- Mild Steel
- Stainless Steel 303
- Stainless Steel 316

[View Our Taper Pin Range](#)

[Request A Quote](#)

[Visit Our Website](#)

[Join Our Community](#)

TECHNIFAST

North Folds Road
Oakley Hay Industrial Estate
Corby, Northants, NN18 9AT

+44 (0) 1536 461140
sales@technifast.co.uk
www.technifast.co.uk



Taper Pins:

Plain, extractable or custom-made taper pins to customer specification

Size Range - Taper Pins to DIN 1B

Nominal Diameter 'd'	1.5	2	2.5	3	4	5	6	8	10	12	14	16	20
Dimension 'C'	0.23	0.3	0.4	0.45	0.6	0.75	0.9	1.0	1.2	1.6	1.6	2.0	2.5
Lengths in mm													
6mm													
8mm													
10mm													
12mm													
14mm													
16mm													
18mm													
20mm													
22mm													
24mm													
26mm													
28mm													
30mm													
32mm													
36mm													
40mm													
45mm													
50mm													
55mm													
60mm													
65mm													
70mm													
80mm													
90mm													
100mm													
110mm													
120mm													
130mm													
140mm													
150mm													

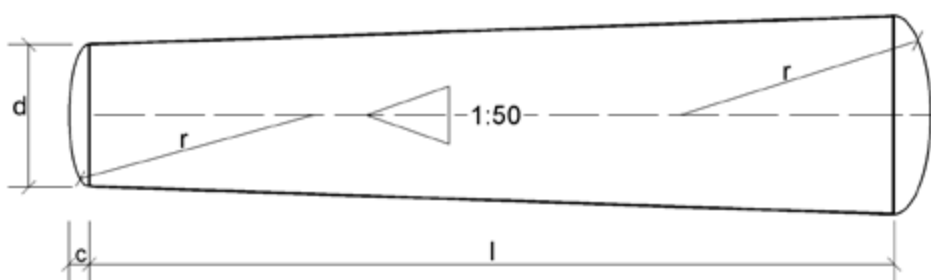

TECHNIFAST

North Folds Road
Oakley Hay Industrial Estate
Corby, Northants, NN18 9AT

+44 (0) 1536 461140
sales@technifast.co.uk
www.technifast.co.uk

Taper Pins:

Plain, extractable or custom-made taper pins to customer specification

Nominal Diameter 'd' DIN 7978 (Female)	6	8	10	12	14	16	20
Thread Size	M4	M5	M6	M8	M8	M10	M12
Lengths in mm							
16mm							
18mm							
20mm							
24mm							
26mm							
28mm							
30mm							
32mm							
36mm							
40mm							
45mm							
50mm							
55mm							
60mm							
70mm							
90mm							
100mm							
110mm							
120mm							

Taper Pins To DIN 7978 (ISO 8736)
With A Female Thread

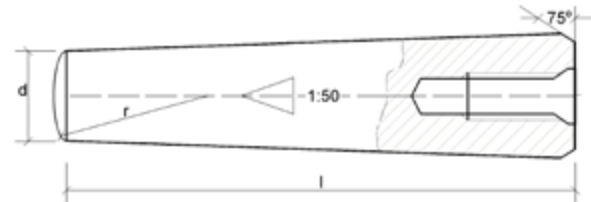

Nominal Diameter 'd' DIN 7977 (Male)	5	6	8	10	12	16
Thread Size	M5	M6	M8	M10	M12	M16
Lengths in mm						
40mm						
45mm						
50mm						
55mm						
60mm						
65mm						
70mm						
75mm						
80mm						
85mm						
90mm						
95mm						
100mm						
110mm						
120mm						
130mm						
140mm						
150mm						
160mm						

Taper Pins To DIN 7977 With A
Male Thread

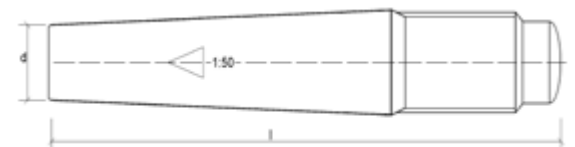

TECHNIFAST

North Folds Road
Oakley Hay Industrial Estate
Corby, Northants, NN18 9AT

+44 (0) 1536 461140
sales@technifast.co.uk
www.technifast.co.uk

All length tolerances to js 15