

Hammer Drive Pins:

Simple, low-cost assembly solution, with installation by hammer or press.

Flat / Round Headed Hammer Drive Pins

Hammer drive pins are cold-formed pins with helical knurls and are used to replace screws where the need to remove the pin is unlikely. Hammer drive pins are designed for installation by hammer or press.

Hammer drive pins are made in low carbon steel and the knurl has to cut its way into the walls of the hold. They are available as in either a round headed or flat headed version and designed for use with unhardened materials such as mild steel, aluminium, brass or plastics.

Features

- Simple, low cost assembly
- Secure - unlike machine screws, hammer drive pins do not depend on tightening torque to be retained in the assembly
- Hammer drive pins do not require lock washers to prevent back-out

Stud Size	1.4	1.6	2.0	2.5	3.0	4.0	5.0	6.0
Diameter 'd1' Min	1.35	1.55	1.95	2.45	2.95	3.95	4.95	5.95
Diameter 'd1' Max	1.40	1.60	2.00	2.50	3.00	4.00	5.00	6.00
Diameter 'd2' Min	1.53	1.73	2.20	2.70	3.25	4.25	5.25	6.25
Diameter 'd2' Max	1.63	1.83	2.30	2.80	3.35	4.35	5.35	6.35
Head Dia. Min	2.20	2.60	3.30	4.20	4.95	6.75	8.50	10.20
Head Dia. Max	2.60	3.00	3.70	4.60	5.45	7.25	9.10	10.80
Round Head Thickness Min	0.70	0.90	1.10	1.40	1.65	2.25	2.85	3.45
Round Head Thickness Max	0.90	1.10	1.30	1.60	1.95	2.55	3.15	3.75
Flat Head Thickness Min	0.35	1.45	0.55	0.70	0.90	1.20	1.50	1.90
Flat Head Thickness Max	0.55	0.65	0.75	0.90	1.20	1.50	1.80	2.20
Chamfer 'C' Min	0.15	0.15	0.15	0.15	0.15	0.40	0.40	0.40
Pilot Length 'P'	1	1	1	1	1	2	2	2
Rec. Hole Dia. Min	1.40	1.60	2.00	2.50	3.00	4.00	5.00	6.00
Rec. Hole Dia. Max	1.46	1.66	2.06	2.56	3.06	4.08	5.08	6.08
Recommended Drill Size	1.40	1.60	2.00	2.55	3.00	4.00	5.00	6.00
Lengths								
5mm								
6mm								
8mm								
10mm								
12mm								
16mm								
20mm								
Length Tolerances	±0.25mm							

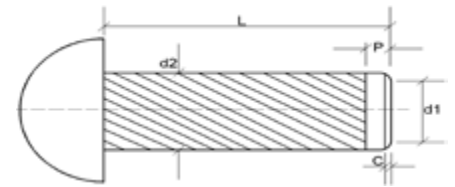

Round Headed Drive Pins - HP 110

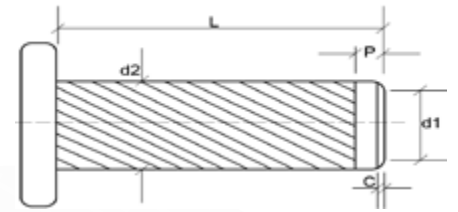

Flat Headed Drive Pins - HP 210



Materials:

- Low Carbon Steel

[View Hammer Drive Pin Range](#)

[Request A Quote](#)

[Visit Our Website](#)

[Join Our Community](#)

TECHNIFAST

North Folds Road
Oakley Hay Industrial Estate
Corby, Northants, NN18 9AT

+44 (0) 1536 461140
sales@technifast.co.uk
www.technifast.co.uk

