

# DOWEL PINS AND EXTRACTABLE DOWELS



Solid & Extractable Dowel Pins in metric and imperial sizes

## Solid & Extractable Dowel Pins

Dowels are solid pins, usually precision ground to narrow limits to permit accurate fitting. Precision dowels are traditionally used to hold parts together in a fixed alignment relying on the tightness of fit to stay in place.

Our stocked range includes stainless steel A2, stainless steel A4, mild steel unhardened and through hardened steel to ISO and DIN standards.

Technifast is able to supply solid dowel pins and extractable dowel pins in both metric and imperial sizes. In addition, we can manufacture dowels with special Diameters, tolerances, lengths or materials to meet your requirements.



## Standards

Dowel pins are manufactured to several national or international standards, each with slight differences in chamfer forms, tolerances and available materials.

- ◆ DIN 6325—Through Hardened to Hrc 58-62 & Ground to m6 tolerance Steel.
- ◆ ISO 2338 (1998)—Mild Steel, Stainless Steel 303 or Stainless Steel 316 in m6 or h8 tolerance.
- ◆ ISO 8734—Type A is through hardened steel, ground to m6 tolerance. Type B is case hardened steel, ground to m6 tolerance. Type C is hardened, martensitic stainless steel. This standard looks identical to ISO 2338.
- ◆ DIN 7—Mild Steel, Stainless Steel 303 or Stainless Steel 316 in m6 or h8 tolerance. Please note, the overall length is greater than the nominal length as dimension 'C' is not included.
- ◆ DIN 7979D—Extractable Dowel, Through Hardened to Hrc 58-62 & Ground to m6 tolerance.
- ◆ BS 1804 Part 1—Imperial solid dowels in steel, unhardened or case-hardened depending on diameter.
- ◆ BS 1804 Part 2—Metric solid dowels, available to order
- ◆ BS 1804 Part 3, Type B—Extractable Dowels and Taper Pins
- ◆ BS 7055—Equivalent to ISO 7834
- ◆ ISO 8733—Equivalent to DIN 7979A (unhardened)
- ◆ ISO 8735—Equivalent to DIN 7979D (hardened)

## Materials (stocked range)

- ◆ Through Hardened Steel
- ◆ Unhardened Mild Steel
- ◆ Stainless Steel 303
- ◆ Stainless Steel 316
- ◆ C1 Stainless

## Hole Tolerances (for guidance only)

Hole/Material	Hardened Steel	Mild Steel	Aluminium / Zinc / Brass
Interference Fit	Pin Ø less 5µm	Pin Ø less 25µm	Pin Ø less 35µm
Transition Fit	Pin Ø less 2µm	Pin Ø less 5µm	Pin Ø less 5µm
Clearance Fit	Pin Ø plus 25-60µm	Pin Ø plus 25-60µm	Pin Ø plus 25-60µm

Technifast Ltd  
North Folds Road  
Oakley Hay Industrial Estate  
CORBY, Northamptonshire, NN18 9AT  
United Kingdom

Tel: +44 (0)1536 461140  
E-Mail: sales@technifast.co.uk

Company No: 2460440 | VAT No GB 550 6965 25  
© 2020 by Technifast Ltd. All Rights Reserved



[Visit Our Website](#)



## DIN 6325, m6 tolerance

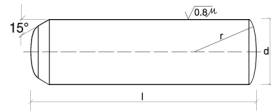

Nominal Diameter, mm	1	1.5	2	2.5	3	4	5	6	8	10	12	14	16	20
Double Shear Strengths—Tested to ISO 8749, kN (based on through hardened & ground steel)														
	1.5	3.4	5.5	8	13	22	31	53	88	132	210	260	350	485
Lengths—from 4mm up to 120, depending on diameter/material. Ask for more information														
Length Tolerance to js14														

## ISO 2338 (1998), m6 and h8 tolerance

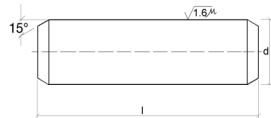

Nominal Diameter, mm	0.8	1	1.5	2	2.5	3	4	5	6	8	10	12	16	20	25	30	
Double Shear Strengths—Tested to ISO 8749, kN																	
Mild Steel	0.4	0.7	1.6	2.85	4.25	6.15	10.6	16.5	22.8	40.5	63.2	91	156	220	300	390	
Stainless 303	0.4	0.7	1.7	2.9	4.4	6.6	11.7	18.1	26.0	47.0	64.1	92	160				
Lengths—from 3mm up to 120, depending on diameter/material. Ask for more information																	
Length Tolerances	3-10mm long ±0.25					12-50mm long ±0.5					Over 50mm long ±0.75						

## DIN 7, m6 and h8 tolerance

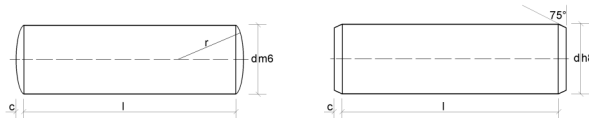

Nominal Diameter, mm	0.8	1	1.5	2	2.5	3	4	5	6	8	10	12	14	16	20	25	30	
Dimension C (max)	0.12	0.15	0.23	0.3	0.4	0.45	0.6	0.75	0.9	1.2	1.5	1.8	2	2.5	3	4	4.5	
Double Shear Strengths—Tested to ISO 8749, kN																		
Mild Steel	0.4	0.7	1.6	2.85	4.25	6.15	10.6	16.5	22.8	40.5	63.5	91	124	156	220	300	390	
Stainless 303	0.4	0.7	1.7	2.9	4.4	6.6	11.7	18.1	26.0	47.0	64.1	92						
Lengths—from 3mm up to 120, depending on diameter/material. Ask for more information																		
Length Tolerances	3-10mm long +0.3 / -0					12-50mm long +0.5 / -0					Over 50mm long +0.8 / -0							

## DIN 7979D

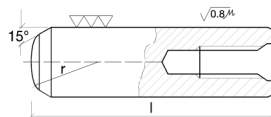

Nominal Diameter, mm	4	5	6	8	10	12	14	16	20
Thread Size	M2.5 / M3 *	M3	M4	M5	M6	M6	M8	M8	M10
Lengths—from 10mm up to 120, depending on diameter/material. Ask for more information									
Length Tolerance to js15									
* Internal Thread size to manufacturers discretion									

Technifast Ltd  
 North Folds Road  
 Oakley Hay Industrial Estate  
 CORBY, Northamptonshire, NN18 9AT  
 United Kingdom

Tel: +44 (0)1536 461140  
 E-Mail: sales@technifast.co.uk

Company No: 2460440 | VAT No GB 550 6965 25  
 © 2020 by Technifast Ltd. All Rights Reserved